

REAR-LOADING CONTAINERS – 2 WHEELS

Clinical Waste Containers

240 L
360 L

Capacity

96 Kg
136 Kg

Nominal load

200/250 mm
200 /300 mm

Wheel diameter



DIMENSIONS

C240L

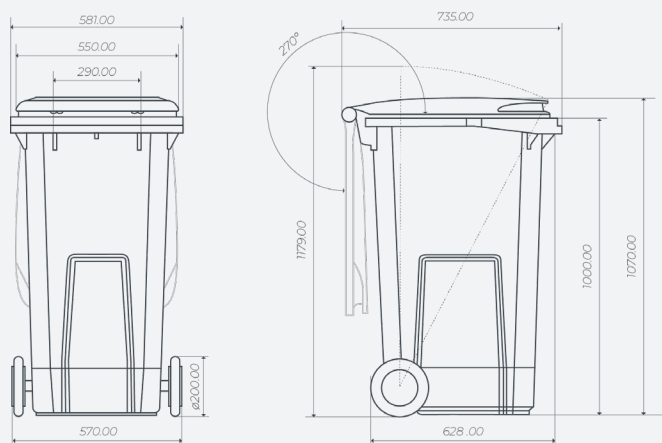

C360L

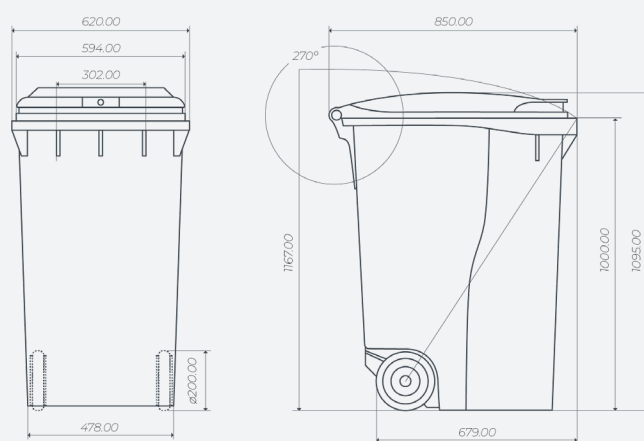

REAR-LOADING CONTAINERS – 2 WHEELS

Clinical Waste Containers

INSTRUCTIONS

- These operating instructions provide useful information for the user. The information is necessary for the proper handling of ADR waste containers.
- For more information on the 240 L and 360 L containers, please consult the CONTENUR website, as well as standards EN 840-1, EN 840-5, EN 840-6, and the certificates in accordance with UN 3291 applicable to this type of container.
- These containers are certified for the storage and transport of infectious substances, Class 6.2, subdivision I3, for clinical waste.
- The containers are intended for the collection of ADR waste (in accordance with standard EN 3291), for which legal transport regulations apply (see applicable national legislation, ADR Regulations, RID Regulations, IMDG Amendment).

CERTIFICATION

- The containers have been certified according to UN 3291 and are marked with the following registration: C240 / C360 UN 50H/Y/*E/**/SE-0015/0/**.
- This hazardous waste marking must be applied on both sides of the container body, on the right side and the left side of the two-wheeled containers C240 and C360 L.

EQUIPMENT AND ACCESSORIES

- The containers are designed for efficient stacking, optimising logistics and reducing CO₂ emissions during transportation.
- The containers can be fitted with a manual lock on the front.
- The containers are equipped with an integrated rear handle in the container body to facilitate handling.
- The lid incorporates an integrated soundproofing system.
- Dedicated housing for the installation of chips to enable container tracking and identification.
- The wheels are designed to minimise dirt adhesion and facilitate cleaning.
- The container body and lid can be customised with logos or other graphics using a sticker or via thermal transfer printing system.
- Body customisation via thermal transfer graphics is available. Maximum size of 260 x 260 mm.



REAR-LOADING CONTAINERS – 2 WHEELS

Clinical Waste Containers

CUSTOMISATION

Can be equipped with a range of accessories providing real solutions to every requirement.



LOCKING SYSTEM



INTEGRATED REAR HANDLE



CUSTOMISATION BY THERMAL
TRANSFER GRAPHIC



SIDE HANDLE