

REAR-LOADING CONTAINERS – 2 WHEELS

C180

180 L
Capacity

72 Kg
Nominal load

200/250 mm
Wheels diameter



DIMENSIONS

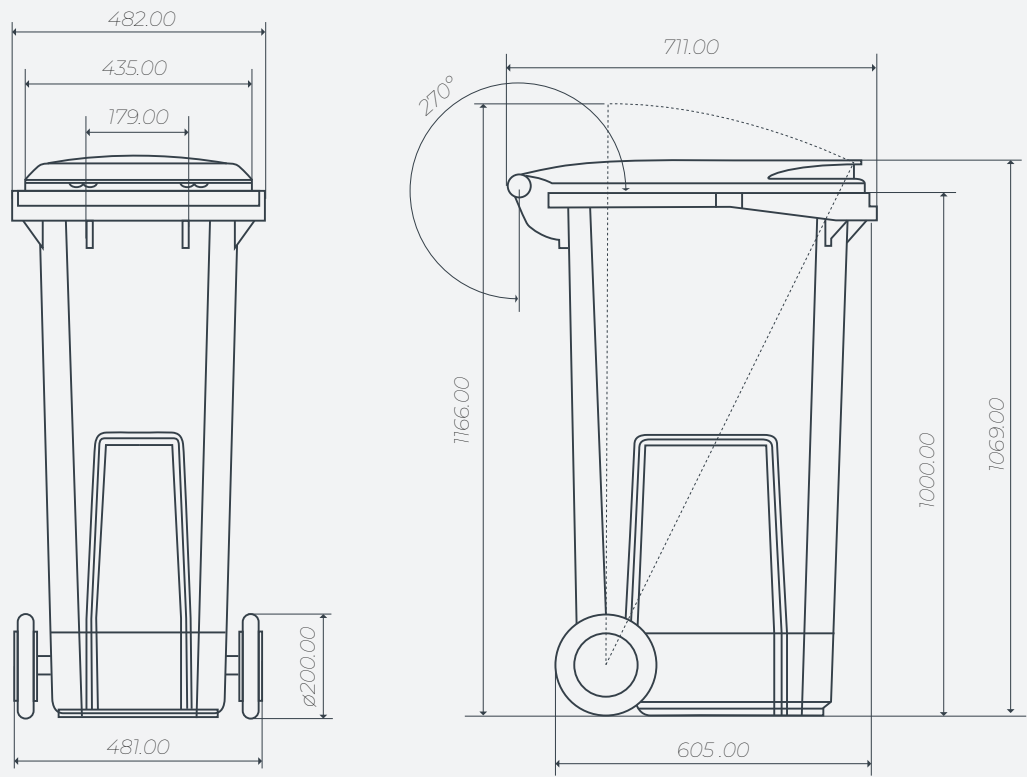

Note: Dimensions are subject to the tolerances specified in EN 840-1:2020.

REAR-LOADING CONTAINERS – 2 WHEELS

C180

FEATURES

- The rear-loading CONTENUR containers are designed with a strong focus on ergonomics and overall aesthetic quality across all components.
- They are manufactured from injection-moulded, solid-colour high-density polyethylene (HDPE), stabilised to resist the combined effects of water and UV radiation.
- The containers are produced using environmentally friendly, fully recyclable materials.
- No heavy metals are used in the pigments.

STANDARDS

- CE marking with noise level indication in accordance with Directive 2000/14/EC of the European Parliament and of the Council, with a value of 81 dB.
- Product certification issued by TÜV Rheinland.

EQUIPMENT AND ACCESSORIES

- The containers are designed for efficient stacking, optimising logistics and reducing CO₂ emissions during transportation.
- The container can be customised for different waste streams, including paper and cardboard, glass, plastics, and organic waste.
- Equipped with DIN-standard lifting systems.
- The lid incorporates an integrated soundproofing system.
- A built-in recess is incorporated for electronic identification chips.
- The wheels are designed to minimise dirt adhesion and facilitate cleaning.
- The container body and lid can be customised with logos or other graphics using a thermal transfer printing system.
- Body customisation via thermal transfer graphics is available. Maximum size of 260 x 260 mm.
- Lid customisation via thermal transfer graphics is available. Maximum size of 45 x 230 mm.



C80



C90



C120



C140



C180



C240



C360

REAR-LOADING CONTAINERS – 2 WHEELS

C180

CUSTOMISATION

Can be equipped with a range of accessories providing real solutions to every requirement.



PAPER SLOT WITH COWL



CIRCULAR OPENING



SIDE HANDLE



CUSTOMISATION BY THERMAL
TRANSFER GRAPHIC



RED DOME LOCK